



## Switches

Altima's range of switches with wafer thin plates no visible fixing.



Backlit switch component produces a **backlit effect**. This can be used with any of the rocker switches.

Ideal for hallways and entrances.



**81.0070.54**

Blue

LED

## Assembly

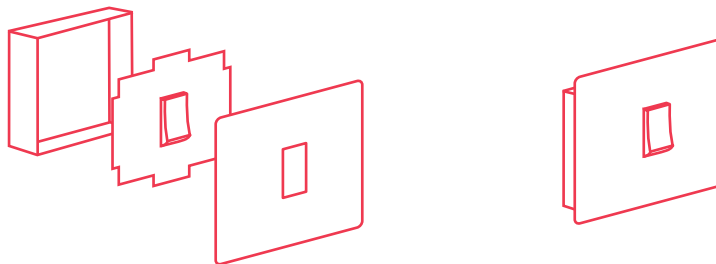

## Wafer Plate Dimensions

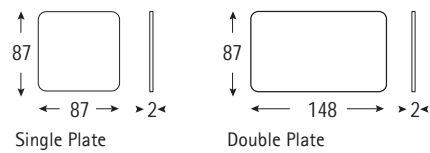

Wall Box Depth - 25mm

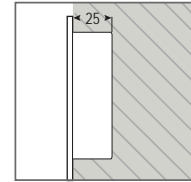

### Switches

#### 1 Gang, 2 Way 10 amp Switch

<b>81.0041.12</b>	Chrome
<b>81.0041.34</b>	Brushed Nickel
<b>81.0041.35</b>	Antique Brass
<b>81.0041.37</b>	Bronze
<b>81.0041.50</b>	Black
<b>81.0041.57</b>	White



#### 20 amp Isolator Switch

<b>81.0018.12</b>	Chrome
<b>81.0018.34</b>	Brushed Nickel
<b>81.0018.35</b>	Antique Brass
<b>81.0018.37</b>	Bronze
<b>81.0018.50</b>	Black
<b>81.0018.57</b>	White



#### 2 Gang, 2 Way 10 amp Switch

<b>81.0042.12</b>	Chrome
<b>81.0042.34</b>	Brushed Nickel
<b>81.0042.35</b>	Antique Brass
<b>81.0042.37</b>	Bronze
<b>81.0042.50</b>	Black
<b>81.0042.57</b>	White



#### 20 amp Isolator Switch with Neon

<b>81.0019.12</b>	Chrome
<b>81.0019.34</b>	Brushed Nickel
<b>81.0019.35</b>	Antique Brass
<b>81.0019.37</b>	Bronze
<b>81.0019.50</b>	Black
<b>81.0019.57</b>	White



#### 1 Gang, Intermediate 10 amp Switch

<b>81.0048.12</b>	Chrome
<b>81.0048.34</b>	Brushed Nickel
<b>81.0048.35</b>	Antique Brass
<b>81.0048.37</b>	Bronze
<b>81.0048.50</b>	Black
<b>81.0048.57</b>	White



#### 32 amp Isolator Switch

<b>81.0032.12</b>	Chrome
<b>81.0032.34</b>	Brushed Nickel
<b>81.0032.35</b>	Antique Brass
<b>81.0032.37</b>	Bronze
<b>81.0032.50</b>	Black
<b>81.0032.57</b>	White



#### 2 Gang, Intermediate 10 amp Switch

<b>81.0049.12</b>	Chrome
<b>81.0049.34</b>	Brushed Nickel
<b>81.0049.35</b>	Antique Brass
<b>81.0049.37</b>	Bronze
<b>81.0049.50</b>	Black
<b>81.0049.57</b>	White



#### 32 amp Isolator Switch with Neon

<b>81.0033.12</b>	Chrome
<b>81.0033.34</b>	Brushed Nickel
<b>81.0033.35</b>	Antique Brass
<b>81.0033.37</b>	Bronze
<b>81.0033.50</b>	Black
<b>81.0033.57</b>	White



#### 3 Gang, 2 Way 10 amp Switch

<b>81.0043.12</b>	Chrome
<b>81.0043.34</b>	Brushed Nickel
<b>81.0043.35</b>	Antique Brass
<b>81.0043.37</b>	Bronze
<b>81.0043.50</b>	Black
<b>81.0043.57</b>	White



#### 45 amp Isolator Switch

<b>81.0046.12</b>	Chrome
<b>81.0046.34</b>	Brushed Nickel
<b>81.0046.35</b>	Antique Brass
<b>81.0046.37</b>	Bronze
<b>81.0046.50</b>	Black
<b>81.0046.57</b>	White



#### Double Plate - Triple 10 amp Switch

<b>81.0050.12</b>	Chrome
<b>81.0050.34</b>	Brushed Nickel
<b>81.0050.35</b>	Antique Brass
<b>81.0050.37</b>	Bronze
<b>81.0050.50</b>	Black
<b>81.0050.57</b>	White



#### 45 amp Isolator Switch with Neon

<b>81.0047.12</b>	Chrome
<b>81.0047.34</b>	Brushed Nickel
<b>81.0047.35</b>	Antique Brass
<b>81.0047.37</b>	Bronze
<b>81.0047.50</b>	Black
<b>81.0047.57</b>	White



#### Double Plate - Quad 10 amp Switch

<b>81.0051.12</b>	Chrome
<b>81.0051.34</b>	Brushed Nickel
<b>81.0051.35</b>	Antique Brass
<b>81.0051.37</b>	Bronze
<b>81.0051.50</b>	Black
<b>81.0051.57</b>	White



#### Triple Isolator Switch 3 x 6 amp

<b>81.0017.12</b>	Chrome
<b>81.0017.34</b>	Brushed Nickel
<b>81.0017.35</b>	Antique Brass
<b>81.0017.37</b>	Bronze
<b>81.0017.50</b>	Black
<b>81.0017.57</b>	White



### Technical Data

Finish	Painted
Material	Brass
Safety	BS 4678
	BS EN 50085-1

